

# Development Management Committee

17 August 2022

Item 09 - Application : 0552/FUL/22

Change of use from open space to private garden ground and erection of decking  
over watercourse (in retrospect)

13 Ballencrieff Mill / Bathgate / EH48 4LL



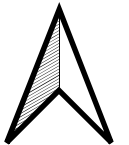





West Lothian  
Council

0552/FUL/22 - 13 Ballencrieff Mill / Bathgate - EH48 4LL

Development Management - West Lothian Civic Centre - EH54 6FF

(c) Crown copyright and database right 2022 OS Licence number 100037194

10 0 10 20 30 m

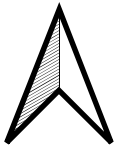
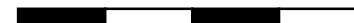

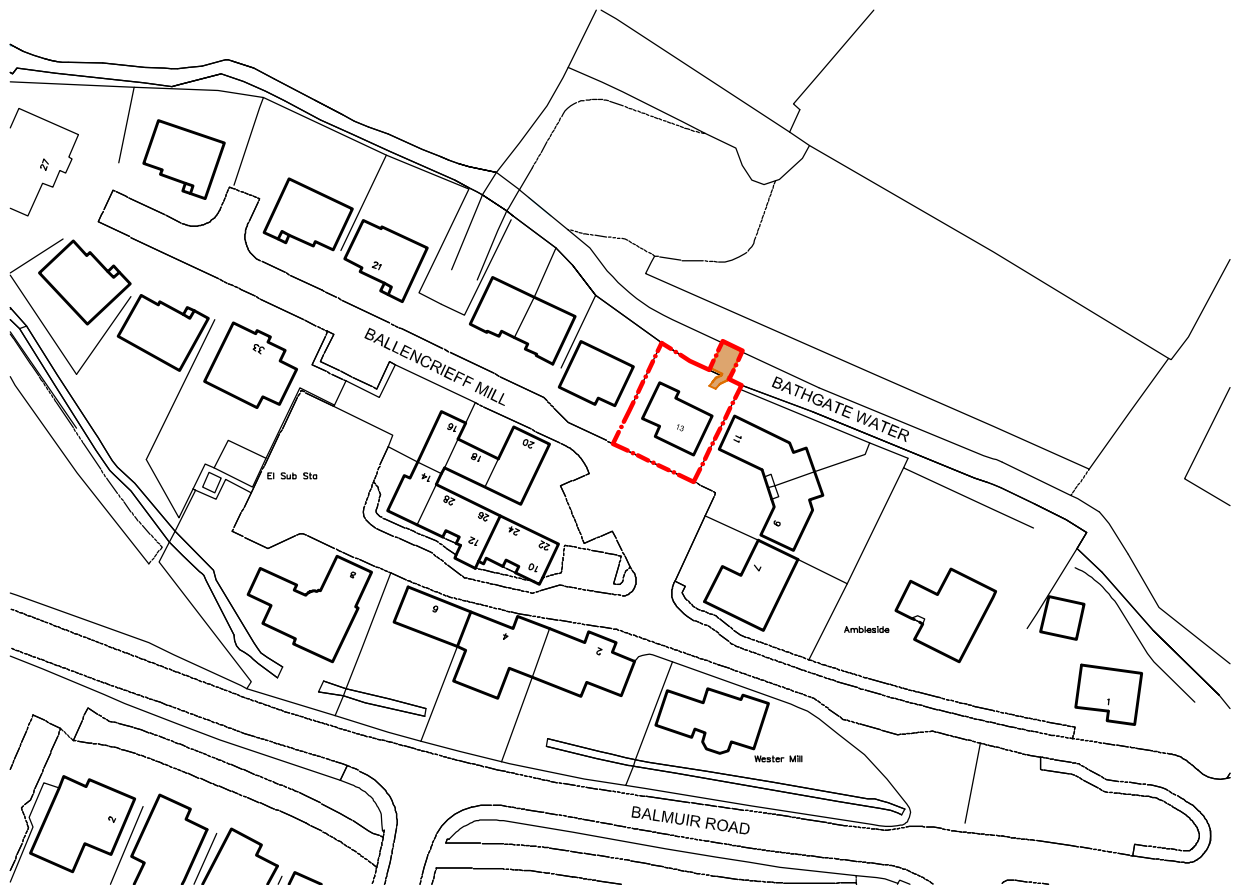

Location Plan. 1:1250.



Proposed Decking,  
13 Ballencrieff Mill,  
Bathgate.

Mr M. Alexander.

Location Plan.

Scale: 1:1250 @ A4. Date: Jul '21.

Drawing No: LP

Rev:

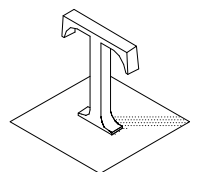

**T-Square**

70, Bellsburn Avenue,  
Linlithgow,  
West Lothian.  
EH49 7LB.

tel 01506 844744



land owned by R W Walker, Eastoun Farm



Proposed Decking, viewed from upstairs bedroom.



Proposed Decking, viewed from back garden.



Proposed Decking construction.

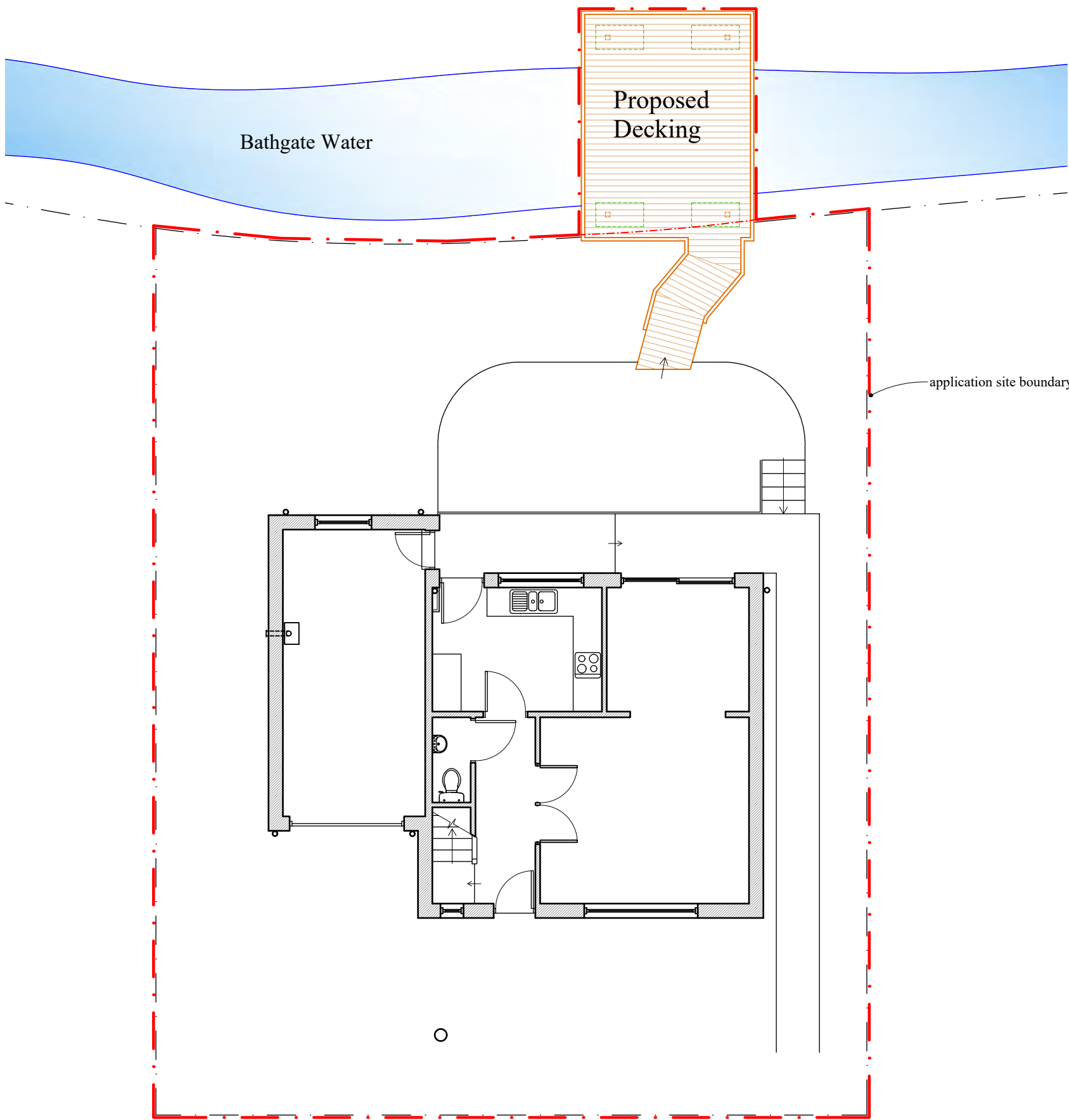

Proposed Site Plan. 1:100.

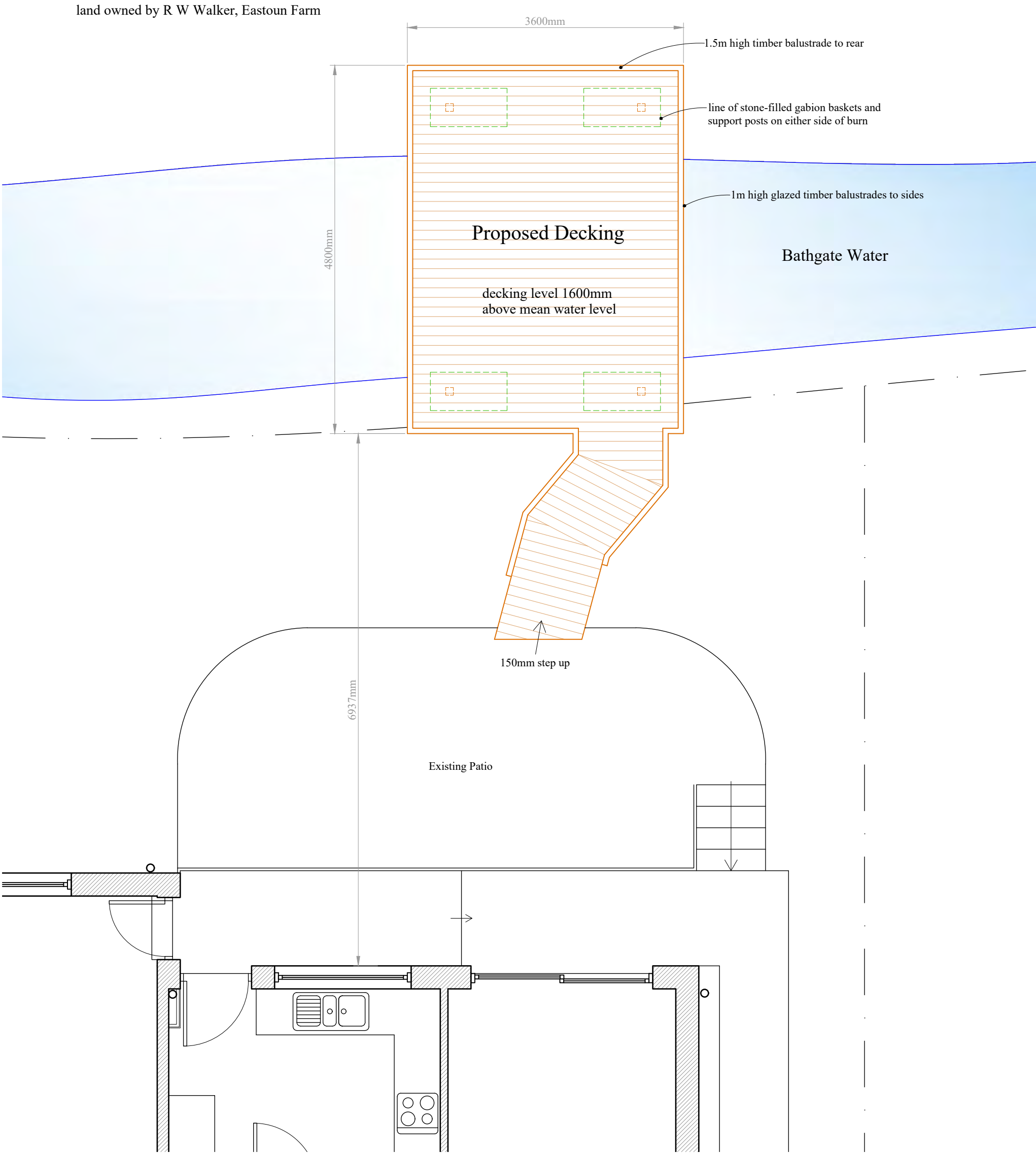

Proposed Decking Plan. 1:50.

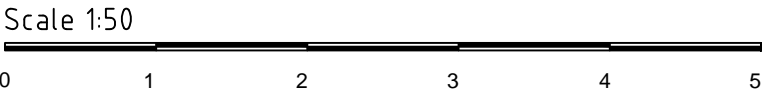

Proposed Decking,  
13 Ballencreeff Mill,  
Bathgate.  
Mr M. Alexander.

Proposed Plans.

Scale: 1:50 @ A1. | Date: Jul '21.  
Drawing No: 01 | Rev:

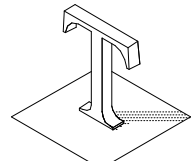

T-Square

70, Bellburn Avenue,  
Lindithgow,  
West Lothian,  
EH49 7LB.  
tel 01506 844744







